

# F COAXIAL CONNECTORS

F connectors have been a standard for the CATV industry for over thirty years. Bodies are nickel-plated with either Delrin or Teflon insulators. Center contacts are available in either gold or tin-lead plating. All connectors are 75 ohm impedance. All dimensions are in millimeters [inches].

C A B L E			G R O U P			L E G E N D		
01	58/ 58A/ 58C/ 141/ 303/ LMR195™/ B7806A	06A	179/ U DOUBLE BRAIDED	09	B8227/ 89207			
01A	55/ 142/ 223/ 400	07	8/ 8A/ 213/ 393	10	.141 SEMI-RIGID/ 402/U			
01B	LMR200™/ B7807A	07A	214	11	.085 SEMI-RIGID/ 405/U			
02	58 PLENUM/THINNET/ 122U/ B88240/ B89907	07B	8X/ LMR240™/ B7808A	12	.250 SEMI-RIGID			
03	59/ 62/ 140/ 210	07C	B9913/ LMR400™/ B7810A/ B8214	13	.047 SEMI-RIGID/ B1674A			
03A	59/ U-20AWG	07D	B89913	14	178/ 196			
04	59/ U PLENUM	07E	11	15	B8281/ B9231/ B9141			
04A	59/ U PLENUM-20AWG	07F	11/ U-14AWG/ B8213/ B9292/ B7731/ B1859A	15A	B88281			
05	174/ 188A/ 316/ B7805A	08	6/ 143/ 212	16	180/ 195/ 122/ B8218/ B1865A/ B1855			
05A	316/ U DOUBLE BRAIDED	08A	B1694A/ B9248	17	LMR600™			
06	179/ 187/ B9221	08B	6 PLENUM/ B1695A	18	AT&T734A/ B1505A			
				19	AT&T735A/ B735A1			

## CRIMP ATTACHMENTS FOR FLEXIBLE AND SEMI-RIGID CABLE

### STRAIGHT CRIMP PLUG — 3-PIECE CRIMP

P.N.	Cable Group	Finish	Insulation	Impedance	Crimp Tool
222119	03	Nickel	Delrin	75	A
222113	06	Nickel	Teflon	75	B
222173	06A	Nickel	Teflon	75	C
222166	07C	Nickel	Teflon	50	D
222175	07E	Nickel	Teflon	75	E
222123	08	Nickel	Delrin	75	E
222126	16	Nickel	Teflon	75	B
222120	19	Nickel	Teflon	75	B

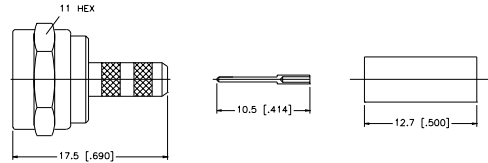

### STRAIGHT CRIMP PLUG — .085 SEMI-RIGID CABLE

P.N.	Cable Group	Finish	Insulation	Impedance	Crimp Tool
222115	11	Bright Tin	Teflon	75	N/A

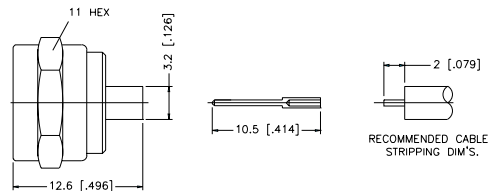

### STRAIGHT CRIMP PLUG — ONE-PIECE CRIMP

P.N.	Cable Group	Finish	Insulation	Impedance	Crimp Tool
222117	03	Nickel	N/A	75	E
222118	08	Nickel	N/A	75	E
222147	16	Nickel	N/A BELDEN 1855A CABLE	75	.260 HEX
222152		Nickel	N/A BELDEN 1186A CABLE RG59/U DOUBLE BRAID COMSCOPE F59 HEC-2	75	E

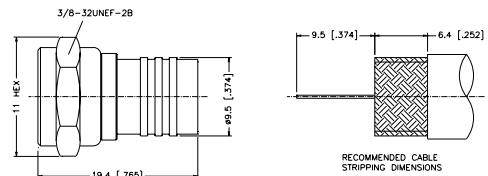
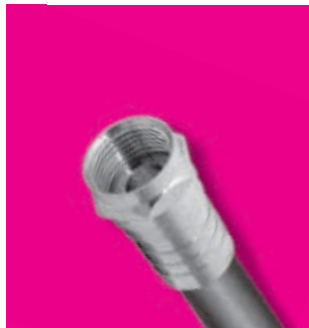

# CRIMP ATTACHMENTS FOR FLEXIBLE AND SEMI-RIGID CABLE

For Cable Group Legend, see page 153

## STRAIGHT PLUG — TWIST-ON

P.N.	Cable Group	Finish	Insulation	Impedance	Crimp Tool
222159	03	Nickel	N/A	75	N/A
222160	08	Nickel	N/A	75	N/A

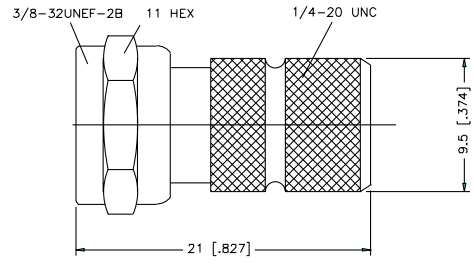
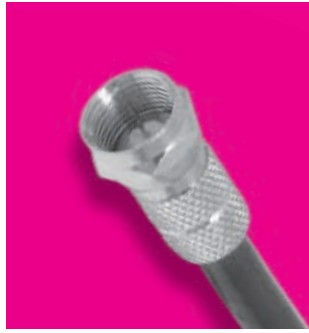

## RIGHT ANGLE CRIMP PLUG

P.N.	Cable Group	Finish	Insulation	Impedance	Crimp Tool
222153	03	Nickel	Teflon	75	A
222164	08	Nickel	Teflon	75	E

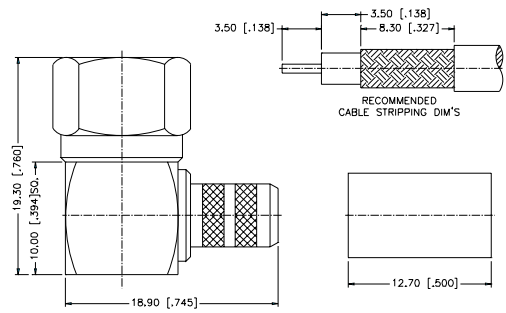
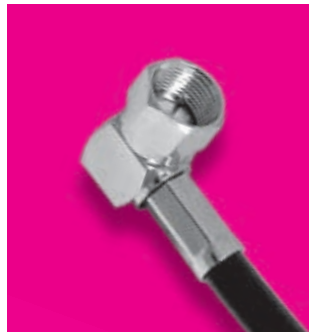

## RIGHT ANGLE PLUG — TWIST-ON

P.N.	Cable Group	Finish	Insulation	Impedance	Crimp Tool
222162	03	Nickel	Delrin	75	N/A
222163	08	Nickel	Delrin	75	N/A

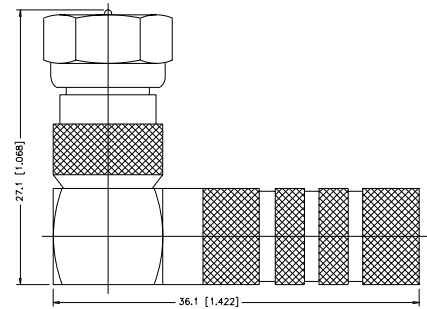

## STRAIGHT CRIMP JACK

P.N.	Cable Group	Finish	Insulation	Impedance	Crimp Tool
222158	03	Tin Lead	P.P.	75	A
222114	06	Tin Lead	P.P.	75	B
222167	06A	Tin Lead	P.P.	75	B
222168	11	Tin Lead	Teflon	75	N/A

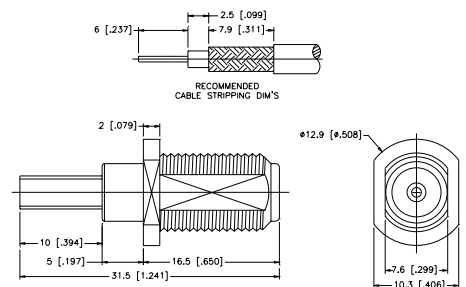

# CRIMP ATTACHMENTS FOR FLEXIBLE AND SEMI-RIGID CABLE

For Cable Group Legend, see page 153

## BULKHEAD CRIMP JACK

P.N.	Cable Group	Finish	Insulation	Impedance	Crimp Tool
222177	01	Nickel	Teflon	50	A
222158-10	03	Nickel	Teflon	75	A
222114-10	06	Tin Lead	P.P.	75	B
222167-10	06A	Tin Lead	P.P.	75	B
222161	08	Nickel	Teflon	75	E
222176	08A	Nickel	Teflon	75	E
222168-10	11	Tin Lead	Teflon	75	N/A
SCTE TYPE INTERFACE					

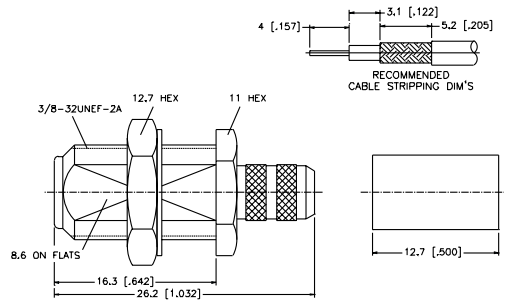

## RECEPTACLES

### BULKHEAD RECEPTACLE

P.N.	Cable Group	Finish	Insulation	Impedance	Crimp Tool
222144	N/A	Nickel	Delrin	75	N/A

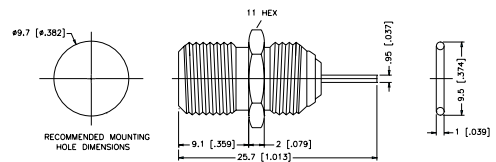

### BULKHEAD RECEPTACLE

P.N.	Cable Group	Finish	Insulation	Impedance	Crimp Tool
222150	N/A	Nickel	P.P.	75	N/A
222150-10	N/A	Nickel	P.P.	75	N/A
WITH HEX NUT AND LOCKWASHER					

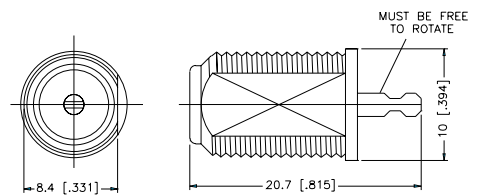

## RECEPTACLES

For Cable Group Legend, see page 153

### BULKHEAD RECEPTACLE

P.N.	Cable Group	Finish	Insulation	Impedance	Crimp Tool
222151	N/A	Nickel	P.P.	75	N/A

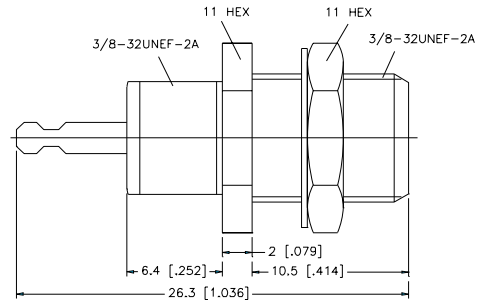

### PANEL RECEPTACLE — EXPOSED TEFLON

P.N.	Cable Group	Finish	Insulation	Impedance	Crimp Tool
222146	N/A	Nickel	Teflon	75	N/A

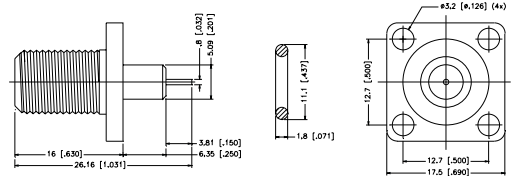

### P.C.B. RECEPTACLE

P.N.	Cable Group	Finish	Insulation	Impedance	Crimp Tool
222141	N/A	Nickel	P.P.	75	N/A

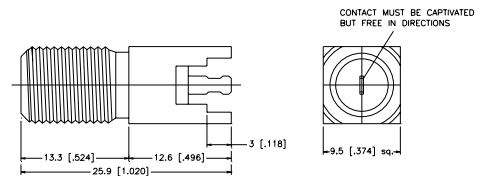

### P.C.B. BULKHEAD RECEPTACLE

P.N.	Cable Group	Finish	Insulation	Impedance	Crimp Tool
222142	N/A	Tin Lead	Teflon	75	N/A

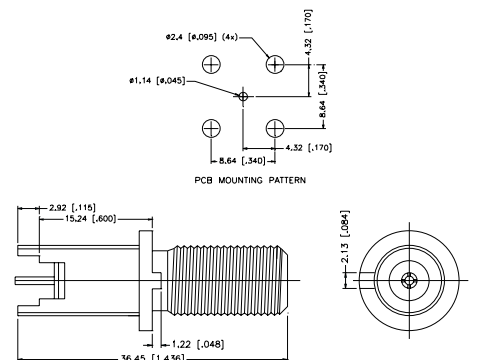

## RIGHT ANGLE P.C.B. RECEPTACLE

P.N.	Cable Group	Finish	Insulation	Impedance	Crimp Tool
222131	N/A	Tin Lead	Teflon	75	N/A

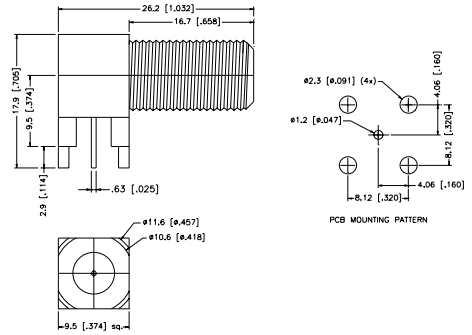

## RIGHT ANGLE P.C.B. RECEPTACLE

P.N.	Cable Group	Finish	Insulation	Impedance	Crimp Tool
222128-10	N/A	Nickel	P.P.	75	N/A
222128-11	N/A	Nickel	P.P. WITH HEX NUT AND LOCK WASHER	75	N/A

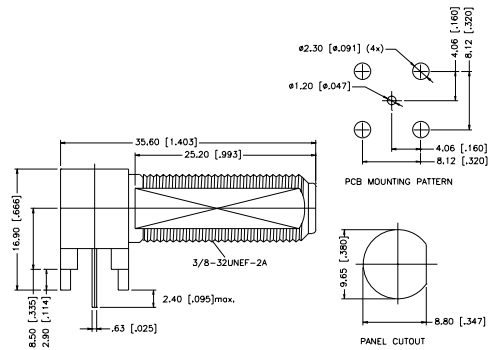

ADAPTERS

For Cable Group Legend, see page 153

**BULKHEAD ADAPTER — JACK-TO-JACK**

P.N.	Cable Group	Finish	Insulation	Impedance	Crimp Tool
222121	N/A	Nickel	P.P.	75	N/A

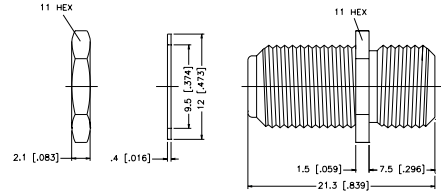

**STRAIGHT ADAPTER — PLUG-TO-PLUG**

P.N.	Cable Group	Finish	Insulation	Impedance	Crimp Tool
222156	N/A	Nickel	Delrin	75	N/A

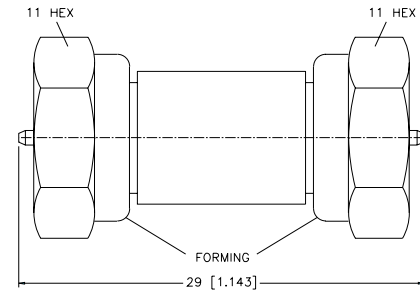
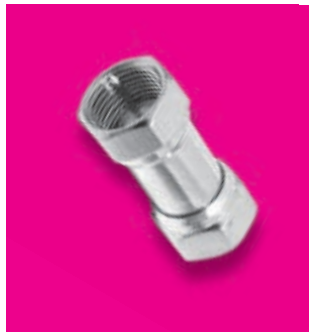

**STRAIGHT ADAPTER — JACK-TO-PUSH-ON PLUG**

P.N.	Cable Group	Finish	Insulation	Impedance	Crimp Tool
222157	N/A	Nickel	P.P.	75	N/A

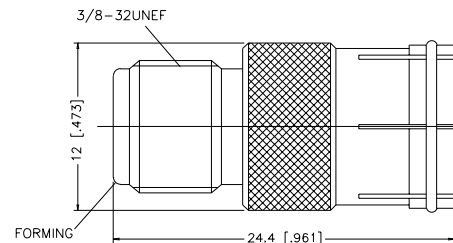

**RIGHT ANGLE ADAPTER — PLUG-TO-JACK**

P.N.	Cable Group	Finish	Insulation	Impedance	Crimp Tool
222122	N/A	Nickel	PP/Delrin	75	N/A

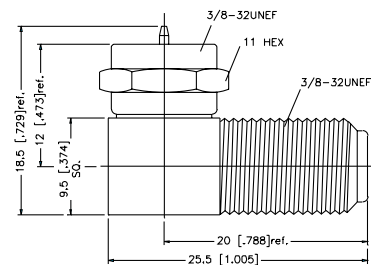

**CAP AND CHAIN — MALE**

P.N.	Cable Group	Finish	Insulation	Impedance	Crimp Tool
222145	N/A	Nickel	N/A	75	N/A

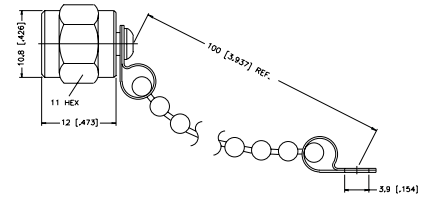

**RESISTOR-TERMINATED — MALE CAP**

P.N.	Cable Group	Finish	Insulation	Impedance	Crimp Tool
222154	N/A	Nickel	Teflon	75	N/A

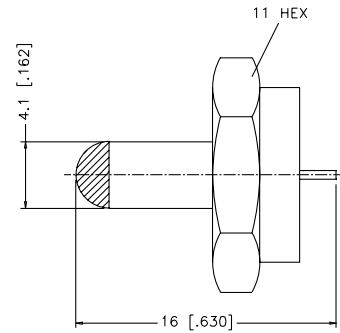

222154

222155	N/A	Nickel PUSH-ON	Teflon	75	N/A
--------	-----	-------------------	--------	----	-----

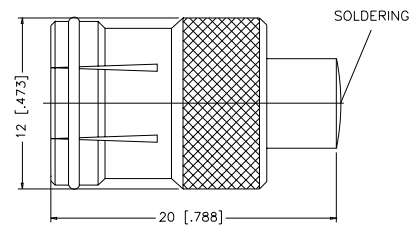

222155

