

BACKSHELLS & PLUGS

Backshells

Straight Clampshell
787-8055-11M
Screws Delivered

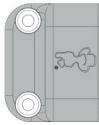

Straight Chimney
787-8055-10M
EN4165-026M10



Straight Chimney
Tie Wrap Ø 7mm
787-8055-12M

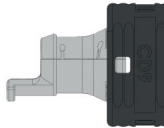

Straight Chimney
Tie Wrap Ø 10mm
787-8055-13M
EN4165-026M10A

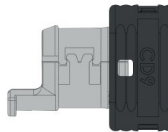

45° Indexable Chimney
787-8055-20M
EN4165-026M20

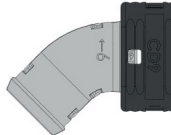

45° Indexable Chimney
Tie Wrap
787-8055-21M
EN4165-026M20A

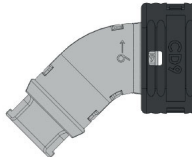

90° Indexable Chimney
787-8055-30M
EN4165-026M30

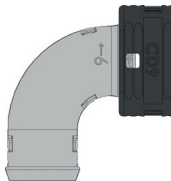

90° Indexable Chimney
Tie Wrap
787-8055-31M
EN4165-026M30A

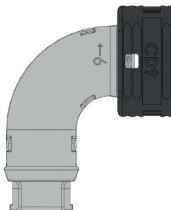

Mates with
↔

Plugs

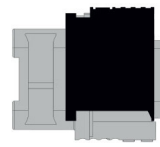

DMC-MD 20 N
BACC65BUMN
EN4165M61AN

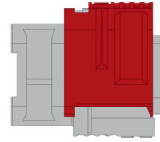

DMC-MD 20 A
BACC65BUMA
EN4165M61AA

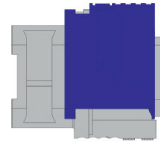

DMC-MD 20 B
BACC65BUMB
EN4165M61AB

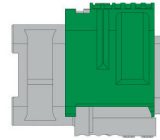

DMC-MD 20 C
BACC65BUMC
EN4165M61AC

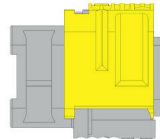

DMC-MD 20 D
BACC65BUMD
EN4165M61AD

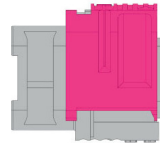

DMC-MD 20 E
EN4165M61AE

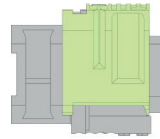

DMC-MD 20 F
EN4165M61AF

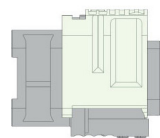

DMC-MD 20 G
EN4165M61AG

TE/DEUTSCH Part Numbers (DMC-M / 787)
BOEING Part Numbers (BACC)
STANDARD Part Numbers (EN4165)

BACKSHELLS & RECEPTACLES

RECEPTACLES

Extender Receptacle
DMC-MD 26 *X
BACC65CAM*X
EN4165M71A*X

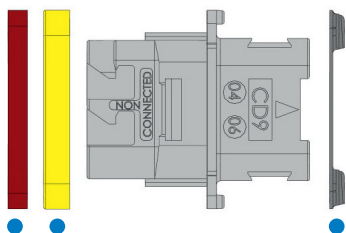

● = To be ordered separately (no BACC65 references)

SHELL KEYING

*X							
N	A	B	C	D	E	F	G

Short Receptacle
DMC-MD 24 *X
BACC65BVM*X
EN4165M01A*X

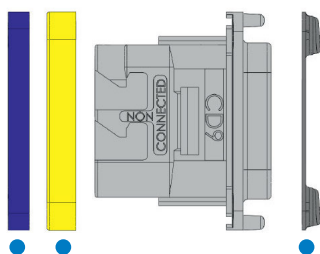

● = To be ordered separately (no BACC65 references)

NOTE: No accessory can be fixed on this receptacle.

Mates with
↔

BACKSHELLS

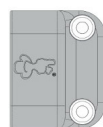

Straight Clampshell
787-8055-11M
Screws Delivered

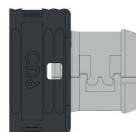

Straight Chimney
787-8055-10M
EN4165-026M10

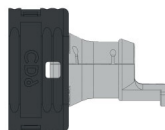

Straight Chimney
Tie Wrap Ø 7mm
787-8055-12M

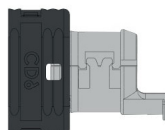

Straight Chimney
Tie Wrap Ø 10mm
787-8055-13M
EN4165-026M10A

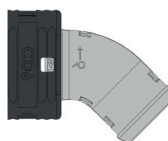

45° Indexable Chimney
787-8055-20M
EN4165-026M20

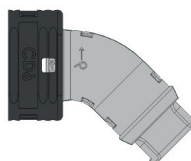

45° Indexable Chimney
Tie Wrap
787-8055-21M
EN4165-026M20A

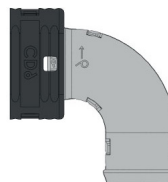

90° Indexable Chimney
787-8055-30M
EN4165-026M30

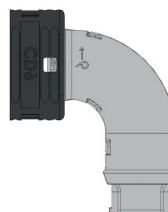

90° Indexable Chimney
Tie Wrap
787-8055-31M
EN4165-026M30A

TE/DEUTSCH Part Numbers (DMC-M / 787)
BOEING Part Numbers (BACC)
STANDARD Part Numbers (EN4165)

PIN CONTACTS PER AS39029/58 AND EN3155

MODULES	DETAILS	PART NUMBER CROSS
	20 contacts size 22	DMC-M 20-22 AN BAC10BC2022PNB EN4165A20-221NA
	20 contacts size 22	DMC-MA 20-22 AN EN4165A20A221NA
	12 contacts size 20	DMC-M 12-20 AN BAC10BC1220PNB EN4165A12-201NA
	8 contacts size 16	DMC-M 08-16 AN BAC10BC0816PNB EN4165A08-161NA
	4 contacts size 12	DMC-M 04-12 AN EN4165A04-121NA
	1 contact size 8	DMC-M 01-08 AN EN4165A01-081NA
	6 contacts size 16 2 contacts size 22 8 contacts size 24	DMC-M 16-02 AN 2226454-1
	6 contacts size 16 5 contacts size 22	DMC-M 99-01 AN BAC10BC1622PNB EN4165A99-011NA
	6 contacts size 16 5 contacts size 22	DMC-MA 99-01 AN EN4165A99A011NA
	8 contacts size 22 3 contacts size 20	DMC-M 99-02 AN
	8 contacts size 20 8 contacts size 24	DMC-M 99-03 AN
	6 contacts size 20 2 contacts size 22 8 contacts size 24	DMC-M 99-04 AN
	8 contacts size 22 2 contacts size 12	DMC-M 99-06 AN BAC10BC1001PNB
	8 contacts size 20 2 contacts size 16	DMC-M 99-10 AN EN4165A99-101NA
	6 optical contacts	DMC-M MC5 AN
	2 optical contacts 5 contacts size 16 2 contacts size 22	DMC-M T47 AN
	12 or 24 optical contacts for round or ribbon cable	Hermaphrodite DMC-M MC6
	Blanking module	DMC-M 00-00 PN EN4165-1N

Aluminum Cable Technology

High Speed Modules

Distribution Shunt Modules

SOCKET CONTACTS PER AS39029/57 AND EN3155

MODULES	DETAILS	PART NUMBER CROSS
	20 contacts size 22	DMC-M 20-22 BN BAC10BC2022SNB EN4165 20-22 A1NB
	20 contacts size 22	DMC-MA 20-22 BN EN4165A20A221NB
	12 contacts size 20	DMC-M 12-20 BN BAC10BC1220SNB EN4165A12-201NB
	8 contacts size 16	DMC-M 08-16 BN BAC10BC0816SNB EN4165A08-161NB
	4 contacts size 12	DMC-M 04-12 BN EN4165A04-121NB
	1 contact size 8	DMC-M 01-08 BN EN4165A01-081NB
	6 contacts size 16 2 contacts size 22 8 contacts size 24	DMC-M 16-02 BN 2226455-1
	6 contacts size 16 5 contacts size 22	DMC-M 99-01 BN BAC10BC1622SNB EN4165A99-011NB
	6 contacts size 16 5 contacts size 22	DMC-MA 99-01 BN EN4165A99A011NB
	8 contacts size 22 3 contacts size 20	DMC-M 99-02 BN
	8 contacts size 20 8 contacts size 24	DMC-M 99-03 BN
	6 contacts size 20 2 contacts size 22 8 contacts size 24	DMC-M 99-04 BN
	8 contacts size 22 2 contacts size 12	DMC-M 99-06 BN BAC10BC1001SNB
	8 contacts size 20 2 contacts size 16	DMC-M 99-10 BN EN4165A99-101NB
	6 optical contacts	DMC-M MC5 BN
	2 optical contacts 5 contacts size 16 2 contacts size 22	DMC-M T47 BN
	20 contacts size 22 5 shunts 4 ways	DMC-M 22-05 BN EN4165A20Y221NB
	20 contacts size 22 3 shunts 4 ways 4 shunts 2 ways	DMC-M 22-07 BN EN4165A2AY221NB
	20 contacts size 22 10 shunts 2 ways	DMC-M 22-10 BN EN4165A2BY221NB

Note: 1) DMC-M modules are compatible with Aluminum Cable contacts and with EN3155-70 / 71 size 22. 2) Distribution shunt modules use dedicated contacts based on standard M39029. 3) DMC-M 99-02, 99-03, 99-04, 16-02 are specific modules for high speed Ethernet application.

TE/DEUTSCH Part Numbers (DMC-M / 787)
BOEING Part Numbers (BAC10)
STANDARD Part Numbers (EN4165)