

**CABLE (SIZE 8) LOOSE CONTACTS – COAXIAL 75 OHM**

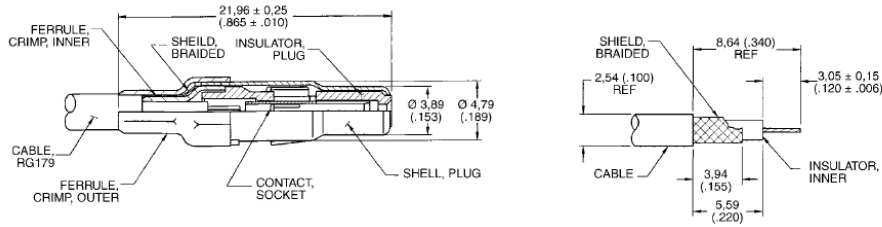

	RG CABLE NUMBER	KIT GOLD OVER NI	KIT 30 IN. GOLD OVER NI	KIT 50 IN. GOLD OVER NI	CENTER CRIMP TOOL	OUTER CRIMP TOOL
PLUG	RG 179/U	D130322-2	D130322-1	D130322-6	CHT-750HM	CCTP-DM
RECEPTACLE	RG 179/U	D130344-1	D130344	D130344-2	CHT-750HM	CCTP-DM

**CABLE (SIZE 8) LOOSE CONTACTS – COAXIAL 50 OHM – STRAIGHT**

**STRAIGHT CRIMP BRAID**

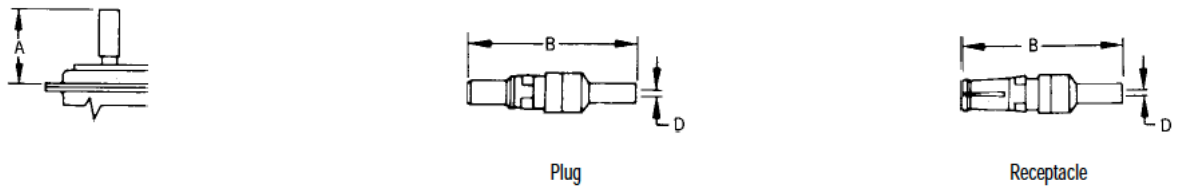

	RG CABLE NUMBER		PART NUMBER GOLD OVER NICKEL	PART NUMBER 50µ IN. GOLD OVER COPPER	A MAX.	B MAX.	D MIN.
	OLD	NEW					
Plug	196/U	178B/U	DM53740	DM53740-17	18,80 (.739)	24,00 (.945)	1,00 (.040)
Plug	187/U 188/U	179B/U 316B/U	DM53740-1	DM53740-15	18,80 (.739)	24,00 (.945)	1,70 (.067)
Plug	-	RD316	DM53740-35	-	18,80 (.739)	24,00 (.945)	1,70 (.067)
Plug	195/U	180B/U	DM53740-3	DM53740-16	21,50 (.847)	26,34 (1.037)	2,79 (.110)
Plug	58/U	58B/U	DM53740-5	DM53740-18	21,50 (.847)	26,34 (1.037)	3,18 (.125)
Receptacle	196/U	178B/U	DM53742	DM53742-18	18,80 (.739)	24,00 (.945)	1,00 (.040)
Receptacle	187/U 188/U	179B/U 316B/U	DM53742-1	DM53742-16	18,80 (.739)	24,00 (.945)	1,70 (.067)
Receptacle	-	RD316	DM53742-36	-	18,80 (.739)	24,00 (.945)	1,70 (.067)
Receptacle	195/U	180B/U	DM53742-3	DM53742-17	21,50 (.847)	26,34 (1.037)	2,79 (.110)
Receptacle	58/U	58B/U	DM53742-5	DM53742-19	21,50 (.847)	26,34 (1.037)	3,18 (.125)

**STRAIGHT SOLDER BRAID**

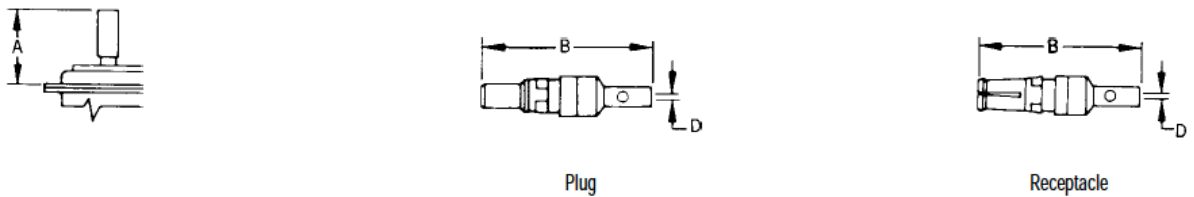

	RG CABLE NUMBER		PART NUMBER GOLD OVER NICKEL	PART NUMBER 50µ IN. GOLD OVER COPPER	A MAX.	B MAX.	D MIN.
	OLD	NEW					
Plug	196/U	178B/U	DM53740-5008	DM53740-5105	18,80 (.739)	24,00 (.945)	1,00 (.040)
Plug	187/U 188/U	179B/U 316B/U	DM53740-5001	DM53740-5099	18,80 (.739)	24,00 (.945)	1,70 (.067)
Plug	-	RD316	DM53740-5145	-	18,80 (.739)	24,00 (.945)	1,70 (.067)
Plug	195/U	180B/U	DM53740-5002	DM53740-5104	21,50 (.847)	26,34 (1.037)	2,79 (.110)
Plug	58/U	58/U	DM53740-5005	DM53740-5101	21,50 (.847)	26,34 (1.037)	3,18 (.125)
Plug (Short Type)	196/U	178B/U	DM53740-5000	DM53740-5100	17,00 (.670)	22,20 (.874)	1,14 (.045)
Receptacle	196/U	178B/U	DM53742-5006	DM53742-5092	18,80 (.739)	24,00 (.945)	1,00 (.040)
Receptacle	187/U 188/U-	179B/U 316B/U	DM53742-5001	DM53742-5089	18,80 (.739)	24,00 (.945)	1,70 (.067)
Receptacle	-	RD316	DM53742-5126	-	18,80 (.739)	24,00 (.945)	1,70 (.067)
Receptacle	195/U	180B/U	DM53742-5002	DM53742-5091	21,50 (.847)	26,34 (1.037)	2,79 (.110)
Receptacle	58/U	58/U	DM53742-5004	DM53742-5086	21,50 (.847)	26,34 (1.037)	3,18 (.125)
Receptacle (Short Type)	196/U	178B/U	DM53742-5000	DM53742-5085	17,00 (.670)	22,20 (.874)	1,14 (.045)

For crimp tooling and extraction tool, → see page 173.

All dimensions in millimeters (inches in parentheses)

CABLE (SIZE 8) LOOSE CONTACTS – COAXIAL 50 OHM – 90°

90° CRIMP BRAID

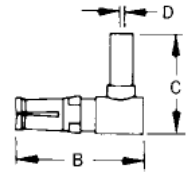
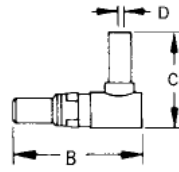
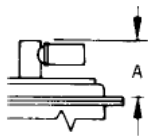

Plug

Receptacle

	RG CABLE NUMBER		PART NUMBER GOLD OVER NICKEL	PART NUMBER 50µ IN. GOLD OVER COPPER	A MAX.	B MAX.	C	D ±0,13 (.005)
	OLD	NEW						
PLUG	196/U	178B/U	DM53741	DM53741-12	13,46 (.530)	18,92 (.745)	15,10 (.594)	1,14 (.045)
PLUG	187/U 188/U	179B/U 316B/U	DM53741-1	DM53741-11	13,46 (.530)	18,92 (.745)	15,10 (.594)	1,83 (.072)
PLUG	195/U	180B/U	DM53741-3	DM53741-10	13,46 (.530)	18,92 (.745)	16,00 (.630)	2,79 (.110)
PLUG	58/U	58B/U	DM53741-4	DM53741-13	13,46 (.530)	18,92 (.745)	16,00 (.630)	3,18 (.125)
RECEPTACLE	196/U	178B/U	DM53743-2	DM53743-18	13,46 (.530)	18,92 (.745)	15,09 (.594)	1,14 (.045)
RECEPTACLE	187/U 188/U	179B/U 316B/U	DM53743-3	DM53743-16	13,46 (.530)	18,92 (.745)	15,09 (.594)	1,83 (.072)
RECEPTACLE	195/U	180B/U	DM53743-5	DM53743-17	13,46 (.530)	18,92 (.745)	16,00 (.630)	2,79 (.110)
RECEPTACLE	58/U	58B/U	DM53743-6	DM53743-19	13,46 (.530)	18,92 (.745)	16,00 (.630)	3,18 (.125)

90° SOLDER BRAID

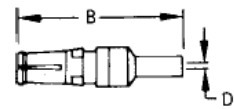
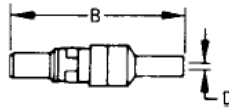
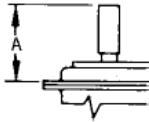

Plug

Receptacle

	RG CABLE NUMBER		PART NUMBER GOLD OVER NICKEL	PART NUMBER 50µ IN. GOLD OVER COPPER	A MAX.	B MAX.	C	D MIN.
	OLD	NEW						
PLUG	196/U	178B/U	DM53741-5000	DM53741-5059	13,46 (.530)	18,92 (.745)	15,10 (.594)	1,00 (.040)
PLUG	187/U 188/U	179B/U 316B/U	DM53741-5001	DM53741-5062	13,46 (.530)	18,92 (.745)	15,10 (.594)	1,70 (.067)
PLUG	195/U	180B/U	DM53741-5003	DM53741-5063	13,46 (.530)	18,92 (.745)	16,00 (.630)	2,79 (.110)
PLUG	58/U	58B/U	DM53741-5004	DM53741-5060	13,46 (.530)	18,92 (.745)	16,00 (.630)	3,18 (.125)
RECEPTACLE	196/U	178B/U	DM53743-5000	DM53743-5073	13,46 (.530)	18,92 (.745)	15,09 (.594)	1,00 (.040)
RECEPTACLE	187/U 188/U	179B/U 316B/U	DM53743-5001	DM53743-5076	13,46 (.530)	18,92 (.745)	15,09 (.594)	1,70 (.067)
RECEPTACLE	195/U	180B/U	DM53743-5003	DM53743-5077	13,46 (.530)	18,92 (.745)	16,00 (.630)	2,79 (.110)
RECEPTACLE	58/U	58B/U	DM53743-5004	DM53743-5074	13,46 (.530)	18,92 (.745)	16,00 (.630)	3,18 (.125)

CRIMP TOOLING



RG CABLE NUMBER	TOOL PART NUMBER	DESCRIPTION	CLOSURE
196/U, 178B/U	070051-0000	CCT-DM	C
187/U, 179B/U, 188/U, 316B/U	070051-0000	CCT-DM	B
195/U, 180B/U, 58/U, 58B/U	070051-0000	CCT-DM	A

EXTRACTION TOOL

CET-C6B-2  
070064-0002



For all size 8 Combo-D contacts, high power, high voltage and coaxial types.

All dimensions in millimeters (inches in parentheses)

**CABLE (SIZE 8) LOOSE CONTACTS – HIGH POWER – SOLDER**

**PLUG**

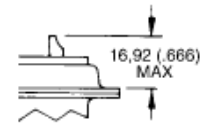
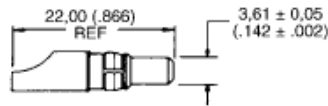

WIRE SIZE	CURRENT RATING	PART NUMBER GOLD OVER NICKEL	PART NUMBER 50µ IN. GOLD OVER COPPER
8 AWG	40 A	DM53745-1	DM53745-28
12 AWG	20 A	DM53745-7	DM53745-27
16 AWG	10 A	DM53745-8	DM53745-25

**RECEPTACLE**

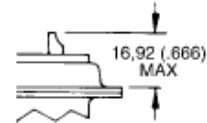
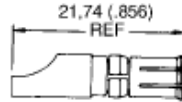

WIRE SIZE	CURRENT RATING	PART NUMBER GOLD OVER NICKEL	PART NUMBER 50µ IN. GOLD OVER COPPER
8 AWG	40 A	DM53744-1	DM53744-21
12 AWG	20 A	DM53744-6	DM53744-25
16 AWG	10 A	DM53744-7	DM53744-24

For extraction tool, ⇨ see page 173

**CABLE (SIZE 8) LOOSE CONTACTS – HIGH POWER – CRIMP**

**PLUG**

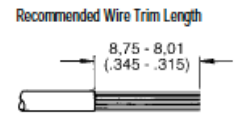
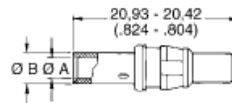

WIRE SIZE	CURRENT RATING	PART NUMBER GOLD OVER NICKEL	PART NUMBER 30 IN. GOLD OVER NI	PART NUMBER 50µ IN. GOLD OVER COPPER	ØA	ØB
8 AWG	40 A	DM130338-4	DM130338	DM130338-1	4,60 (.181)	5,84 (.230)
12 AWG	20 A	DM130339-4	DM130339	DM130339-1	2,54 (.100)	5,54 (.218)
16 AWG	10 A	DM130340-4	DM130340	DM130340-1	1,07 (.067)	2,59 (.102)

**RECEPTACLE**

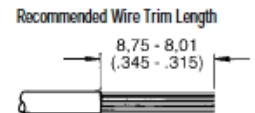
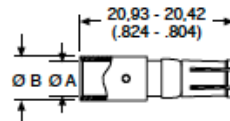

WIRE SIZE	CURRENT RATING	PART NUMBER GOLD OVER NICKEL	PART NUMBER 30 IN. GOLD OVER NI	PART NUMBER 50µ IN. GOLD OVER COPPER	ØA	ØB
8 AWG	40 A	DM130341-4	DM130341	DM130341-1	4,60 (.181)	5,84 (.230)
12 AWG	20 A	DM130342-4	DM130342	DM130342-1	2,54 (.100)	5,54 (.218)
16 AWG	10 A	DM130343-4	DM130343	DM130343-1	1,07 (.067)	2,59 (.102)

For extraction tool, ⇨ see page 173.

**HIGH POWER CRIMP TOOLING**



WIRE SIZE	CRIMP TOOL	LOCATOR (TOOL SETTING NUMBER)
8 AWG	M300-BT	TP968 (6)
10 AWG	M300-BT	TP968 (5)
12/14 AWG	M300-BT	TP968 (1)
16 AWG	FT-8	TH554 (6)
18 AWG	FT-8	TH554 (5)

All dimensions in millimeters (inches in parentheses)

## CABLE (SIZE 8) LOOSE CONTACTS – HIGH VOLTAGE – STRAIGHT

## PLUG

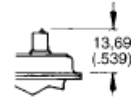
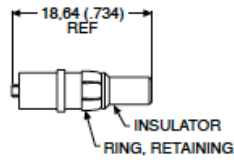

WIRE SIZE	PART NUMBER GOLD OVER NICKEL	PART NUMBER 50 $\mu$ IN. GOLD OVER COPPER
20 AWG	DM51157	DM51157-8

## RECEPTACLE

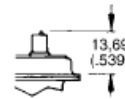
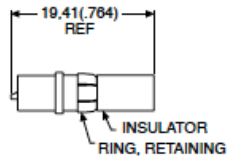

WIRE SIZE	PART NUMBER GOLD OVER NICKEL	PART NUMBER 50 $\mu$ IN. GOLD OVER COPPER
20 AWG	DM51155	DM51155-7

## CABLE (SIZE 8) LOOSE CONTACTS – HIGH VOLTAGE – 90°

## PLUG

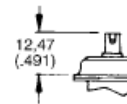
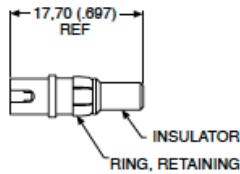

WIRE SIZE	PART NUMBER GOLD OVER NICKEL	PART NUMBER 50 $\mu$ IN. GOLD OVER COPPER
20 AWG	DM51157-5000	DM51157-5005

## RECEPTACLE

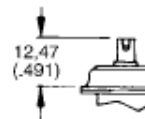
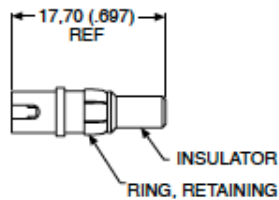

WIRE SIZE	PART NUMBER GOLD OVER NICKEL	PART NUMBER 50 $\mu$ IN. GOLD OVER COPPER
20 AWG	DM51157-5000	DM51155-5004

For extraction tool, [⇒ see page 173.](#)

**PCB (SIZE 8) LOOSE CONTACTS – COAXIAL 75 OHM – STRAIGHT**

**PLUG**

DM130358-2

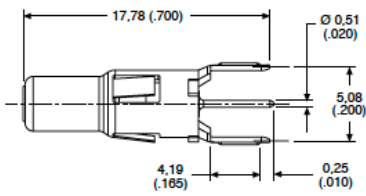

**RECEPTACLE**

DM130346-2

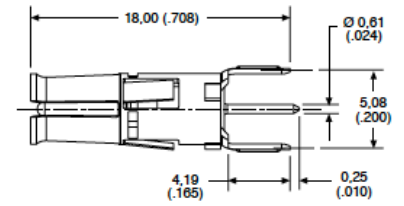

**PCB (SIZE 8) LOOSE CONTACTS – COAXIAL 75 OHM – 90°**

**PLUG**

DM130352-2

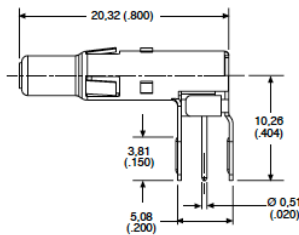

**RECEPTACLE**

DM130321-3

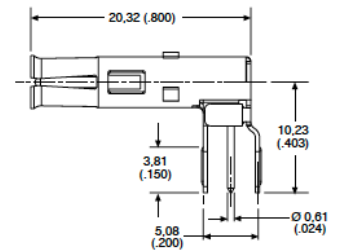

**PCB (SIZE 8) LOOSE CONTACTS – HIGH POWER – STRAIGHT**

**PIN**

DM53745-110

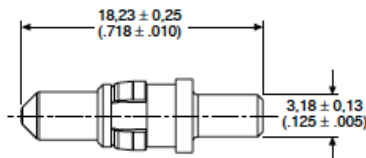

**SOCKET**

DM53744-98

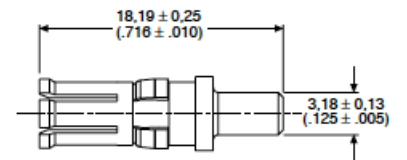

**PCB (SIZE 8) LOOSE CONTACTS – HIGH POWER – 90°**

**PIN**

DM53745-110

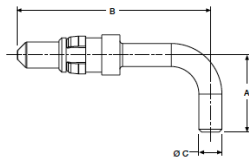

**SOCKET**

DM53744-98

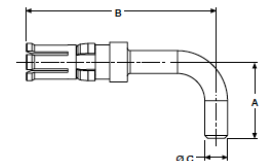

SHELL SIZE	PART NUMBER	A ± 0,25 (.010)	B ± 0,25 (.010)	ØC ± 0,13 (.005)
DE, DA, DB, DC	DM53745-104	10,62 (.418)	26,64 (1.049)	3,18 (.125)
DD	DM53745-107	13,41 (.528)	26,64 (1.049)	3,18 (.125)
EUROPEAN FOOTPRINT DE, DA, DB, DC, DD	DM53745-120	18,06 (.711)	11,00 (.433)	2,90 (.114)

SHELL SIZE	PART NUMBER	A ± 0,25 (.010)	B ± 0,25 (.010)	ØC ± 0,13 (.005)
DE, DA, DB, DC	DM53744-92	13,41 (.528)	26,52 (1.044)	3,18 (.125)
DD	DM53744-95	10,62 (.418)	26,52 (1.044)	3,18 (.125)
EUROPEAN FOOTPRINT DE, DA, DB, DC, DD	DM53744-107	11,00 (.433)	17,93 (.706)	2,90 (.114)

For extraction tool, ⇨ see page 173.

All dimensions in millimeters (inches in parentheses)

PCB (SIZE 8) LOOSE CONTACTS – HIGH POWER –90°

**PIN**

DM53745-110

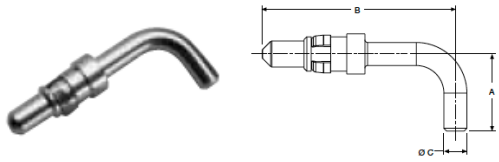

SHELL SIZE	PART NUMBER	A ± 0,25 (.010)	B ±0,25 (.010)	ØC ±0,13 (.005)
DE, DA, DB, DC	DM53745-104	10,62 (.418)	26,64 (1.049)	3,18 (.125)
DD	DM53745-107	13,41 (.528)	26,64 (1.049)	3,18 (.125)
EUROPEAN FOOTPRINT DE, DA, DB, DC, DD	DM53745-120	18,06 (.711)	11,00 (.433)	2,90 (.114)

**SOCKET**

DM53744-98

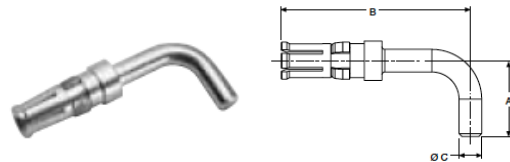

SHELL SIZE	PART NUMBER	A ± 0,25 (.010)	B ±0,25 (.010)	ØC ±0,13 (.005)
DE, DA, DB, DC	DM53744-92	13,41 (.528)	26,52 (1.044)	3,18 (.125)
DD	DM53744-95	10,62 (.418)	26,52 (1.044)	3,18 (.125)
EUROPEAN FOOTPRINT DE, DA, DB, DC, DD	DM53744-107	11,00 (.433)	17,93 (.706)	2,90 (.114)

PCB (SIZE 8) LOOSE CONTACTS – HIGH VOLTAGE – STRAIGHT

**PLUG**

PART NUMBER GOLD OVER NICKEL	PART NUMBER 50µ IN. GOLD OVER COPPER
DM51157-13	DM51157-14

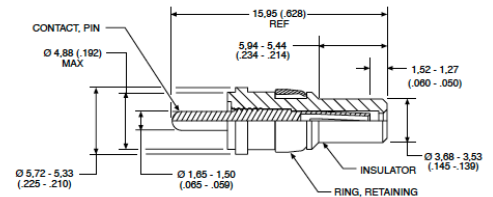

**RECEPTACLE**

PART NUMBER GOLD OVER NICKEL	PART NUMBER 50µ IN. GOLD OVER COPPER
DM51155-12	DM51155-13

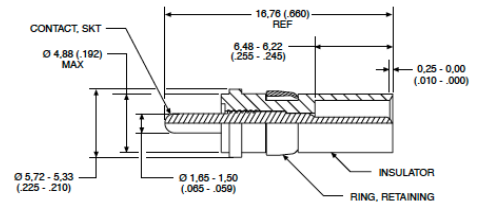

For extraction tool, ⇨ see page 173.

All dimensions in millimeters (inches in parentheses)

**GUIDE PIN AND SOCKET**

Installs into any Combo D, Size 8 cavity. This guide pin and socket system is ideal for blind mate applications where space is limited.



**PCB GUIDE PIN**

PART NUMBER	MATERIAL	FINISH
DM53745-126	COPPER ALLOY	TIN

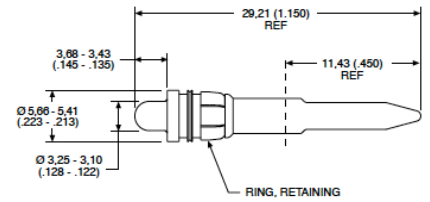

**PCB GUIDE SOCKET**

PART NUMBER	MATERIAL	FINISH
248-2967-000	COPPER ALLOY	TIN

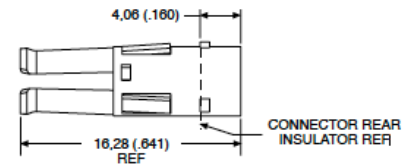

For extraction tool, → see page 173.