

REVISIONS				DRAW	APPD	DATE
REV	ZONE	ECO#	DESCRIPTION			
A			INITIAL RELEASE	AMY	G.SUN	5/20/2019

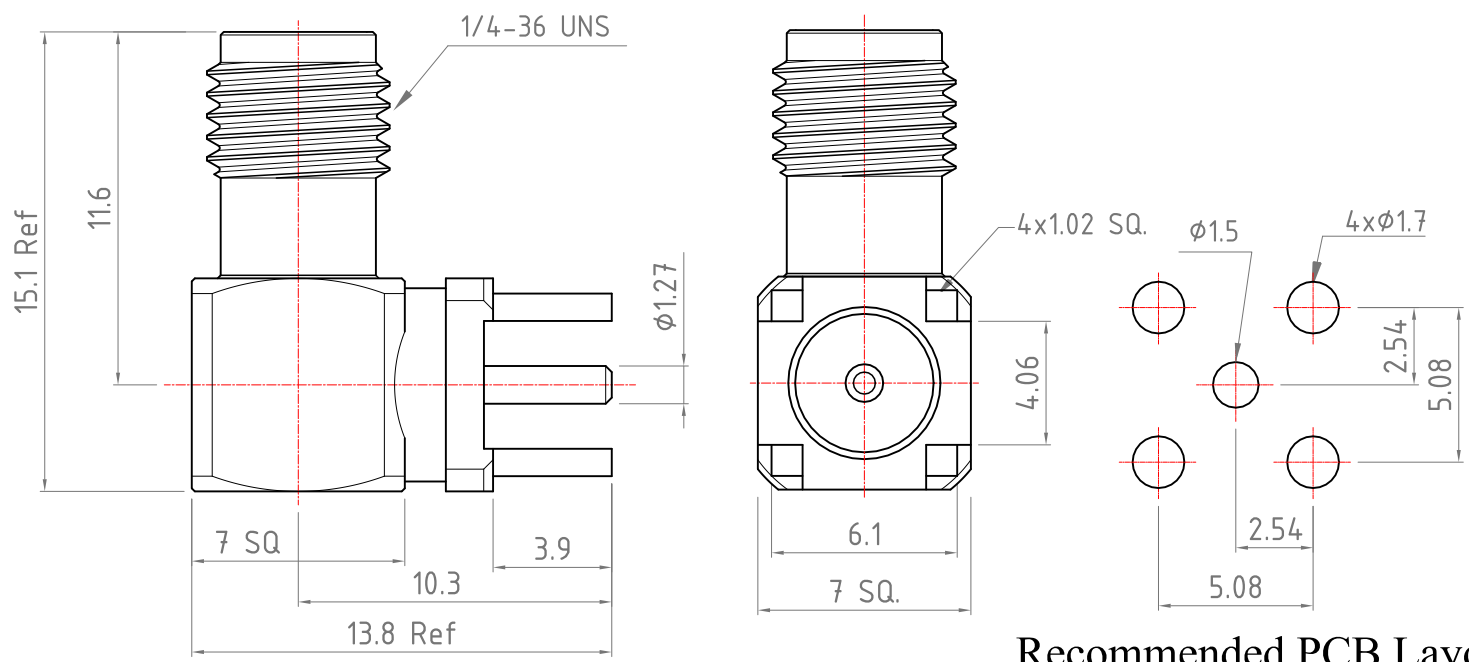

Recommended PCB Layout

Electrical :
 Impedance : 50 ohm
 Frequency Range : 0~12.4 GHz .
 Voltage Rating : 500 V rms. (depending on cable)
 Insulator Resistance : ≥ 5 GΩ
 Dielectric Withstanding Voltage : 1000 V rms .
 Contact Resistance : Inner Contact ≤ 3 mΩ.
 Outer Contact ≤ 2.5 mΩ .

Mechanical :
 Mating : 1/4-36 UNS Screw-on Coupling.
 Recommended Mating Torque : 7.1~9.7 lbs
 Coupling Nut Retention Force : ≥ 60.7 lbs

Environmental :
 Temperature Range : -65°C to 165°C
 Corrosion (Salt Spray) : MIL-STD-202, Method 101, Cond. B
 Thermal Shock : MIL-STD-202, Method 107, Cond. B
 Mechanical : MIL-STD-202, Method 213, Cond. I
 Vibration : MIL-STD-202, Method 204, Cond. D

Finish [Unit of Plating Thickness Is in Micro Inch(μ)]
 1.Copper Strike Plating Thk. : 20 μ"min. (Under Plating)
 2.Nickel Plating Thk. : 120 μ"min. (Over Finish 1)
 3.Gold Plating Thk. : 30 μ"min. (Over Finish 2)
 4.Gold Plating Thk. : 2 μ"max. (Over Finish 2)

ITEM	NAME	DESCRIPTION	QTY	UNIT
A	Body	Brass ; Finish 1/2/4	1	
B	Insulator	PTFE ; None	1	
C	Inner Contact	Brass ; Finish 1/2/3	1	

Notes :
 1. All Metal Materials Are in Compliance with RoHS 2 Directive 2011/65/EU Annex III Section 6 Paragraph.

TITLE: SMA R/A Jack, PCB Mount Type UNLESS OTHERWISE SPECIFIED, DIMENSIONS ARE IN INCHES TOLERANCE EXCEPT AS NOTED: ANGULAR ± X° DECIMAL .XX ± .1 DECIMAL .X ± .2 DECIMAL .XXX ± .05		PART NUMBER: IPRF-S-J09L0G29 DRAWN: AMY APPD: G.SUN DATE: 5/20/2019 REV: A	 2180 Hornig Road, Philadelphia, PA 19166 <small>NOTICE OF CONFIDENTIALITY</small> <small>THIS DRAWING IS THE PROPERTY OF PEI-GENESIS, ALL RIGHTS RESERVED. REPRODUCTION BY ANY MEANS OR DISTRIBUTION TO THIRD PARTIES IS STRICTLY PROHIBITED WITHOUT THE WRITTEN PERMISSION OF AN AUTHORIZED AGENT OF PEI-GENESIS.</small>
THIRD ANGLE PROJECTION SCALE: NTS SHEET 1 OF 1	DRAWING CODE: XXXXX	COPYRIGHT 2018 PEI-GENESIS ENGINEERING PRODUCT DEVELOPMENT	