

PART REV	DWG ISSUE	DATE	ECN NO.	APPVD BY	REL BY

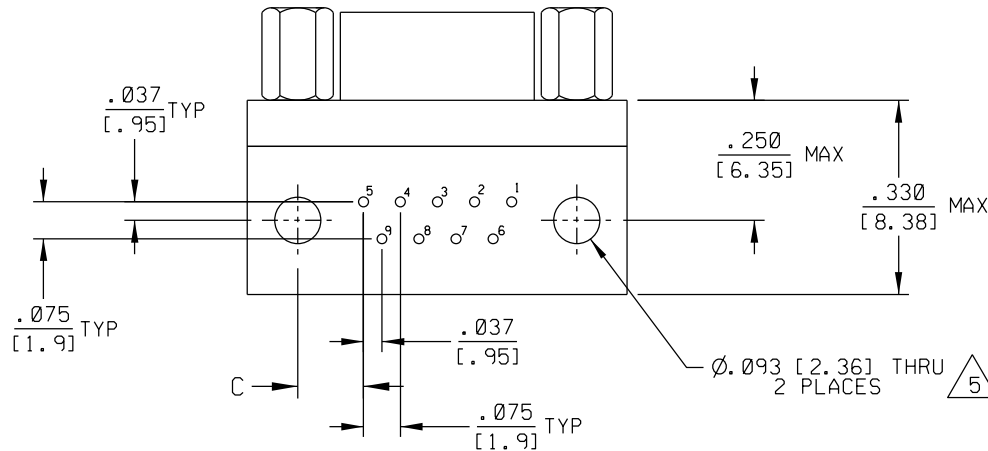
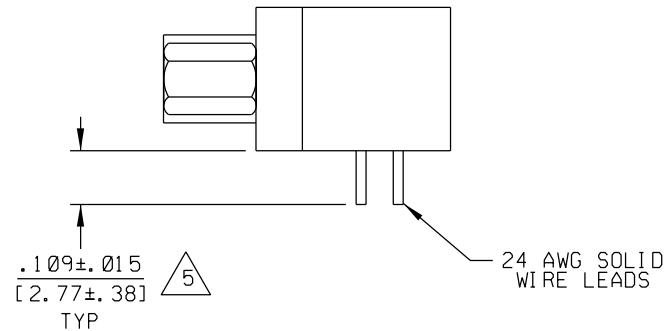
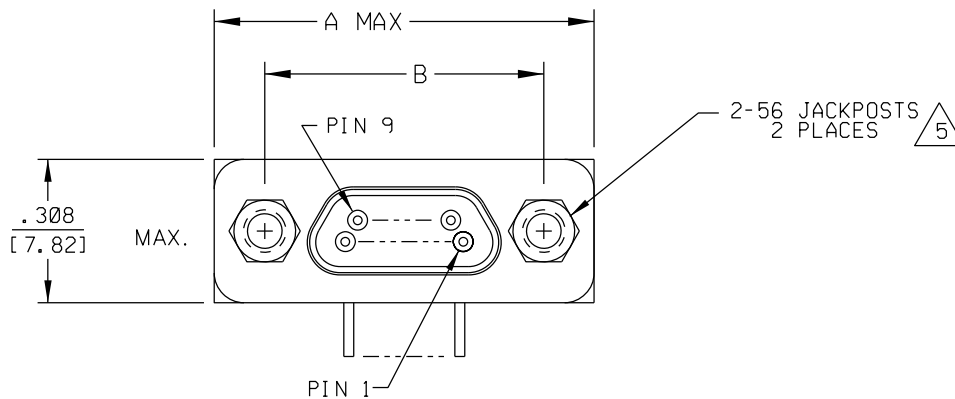

PART NUMBER	SIZE	A MAX	B	C
836111317	9	.785 [19.94]	.565 [14.35]	.133 [3.38]
836121317	15	.935 [23.75]	.715 [18.16]	.170 [4.32]
836131317	21	1.085 [27.56]	.865 [21.97]	.170 [4.32]
836141317	25	1.185 [30.10]	.965 [24.51]	.183 [4.65]
836151317	31	1.335 [33.91]	1.115 [28.32]	.183 [4.65]
836161317	37	1.485 [37.27]	1.265 [32.13]	.183 [4.65]

- 5 CONSULT FACTORY FOR AVAILABLE OPTIONS
- 4. PERFORMANCE: MEETS OR EXCEEDS THE REQUIREMENTS OF MIL-DTL-83513
- 3. SEE SHEET 2 FOR RECOMMENDED PCB LAYOUTS

- 2 MATERIALS:
- SHELL: 6061-T6 ALUMINUM PER AMS-QQ-A200/8, NICKEL PLATED PER AMS 2404
- INSULATOR AND BACKSHELL: PPS PER MIL-M-24519 GST-40F, COLOR: BLACK
- PIN CONTACTS: C17200 BERYLLIUM COPPER PER ASTM B194, GOLD PLATED PER ASTM B488
- 24 AWG LEADS: TIN PLATED COPPER ALLOY PER A-A-59551 TYPE S
- JACKPOSTS: PASSIVATED STAINLESS STEEL IAW MIL-DTL-83513/5

- 1. MARKING: "UMI", DATE CODE, AND UMI PART NUMBER
- NOTES: UNLESS OTHERWISE SPECIFIED

QUALITY SYMBOLS MAJOR CRITICAL SPC	UNLESS SPECIFIED: ALL DIMENSIONS IN INCHES/MM	SCALE NONE	DWG SIZE B	THIRD ANGLE PROJECTION	REVISE ON CAD ONLY
	GENERAL TOLERANCES: 3 PLACE ±.002/.051 2 PLACE ±.005/.13 ANGULAR ±2°	DRAWN BY & DATE DW 2-6-12		TITLE: CIRCUIT CONNECTOR, PLUG, STYLE 9 (.075 X .075), SIZES 9 THRU 37, CM9RXXP07-S01	
	Ulti-Mate CAGE CODE 58967	APPROVED BY & DATE		MATERIAL: 2 5 Ulti-Mate Connector Inc.	
		CAD FILENAME SD-8361 X1 31 7-1.DGN	PART NO. SEE CHART	DRAWING NO. SD-8361 X1 31 7	SHEET NO. 1 OF 2

THIS DRAWING CONTAINS INFORMATION THAT IS PROPRIETARY TO ULTI-MATE INCORPORATED AND SHOULD NOT BE USED WITHOUT WRITTEN PERMISSION.

PART REV	DWG ISSUE	DATE	ECN NO.	APPVD BY	REL BY

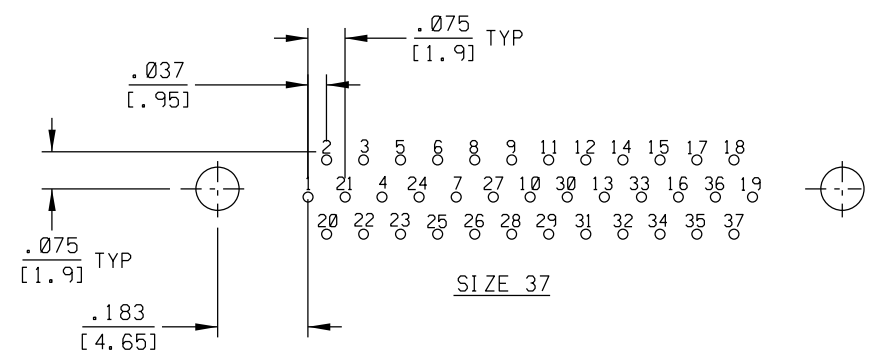
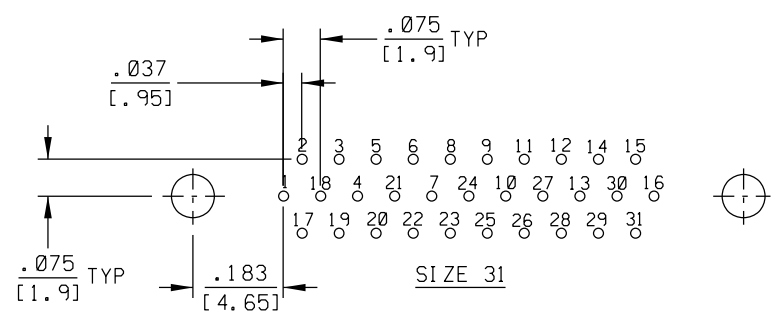
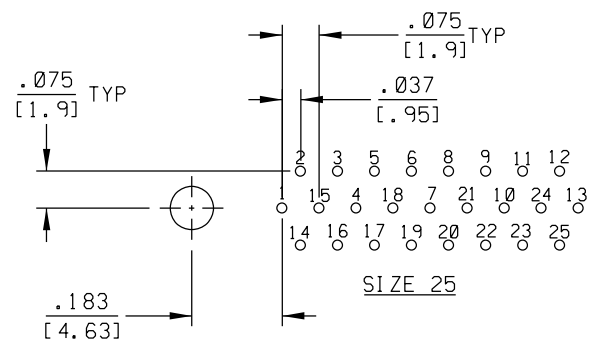
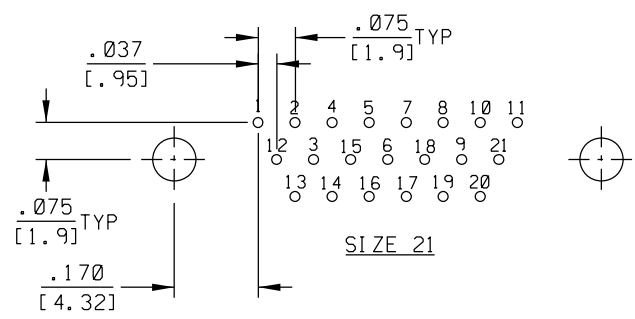
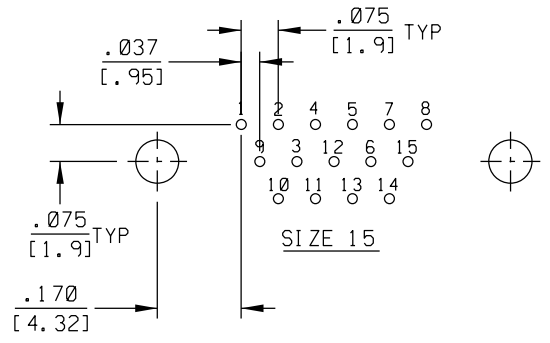
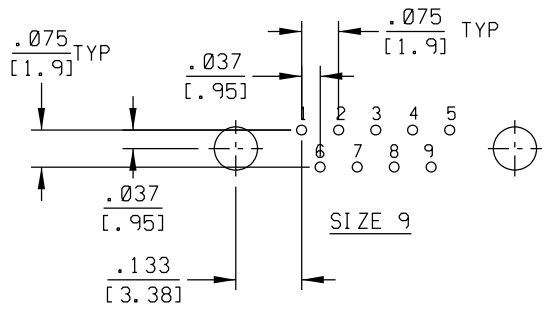

QUALITY SYMBOLS MAJOR ▽ = CRITICAL ▽ C = SPC ▽ S =	UNLESS SPECIFIED: ALL DIMENSIONS IN INCHES/MM	SCALE 4:1 DWG SIZE B	THIRD ANGLE PROJECTION	REVISE ON CAD ONLY	
	GENERAL TOLERANCES: 3 PLACE ±.002/.051 2 PLACE ±.005/.13 ANGULAR ±2°	DRAWN BY & DATE DW 2-6-12	TITLE: RECOMMENDED PCB LAYOUTS, STYLE 9 PLUG (.075 X .075), SIZES 9 THRU 37, CM9RXXP07-S01		
	Ulti-Mate CAGE CODE 58967	CHECKED BY & DATE	MATERIAL: SEE SHEET 1		
	CAD FILENAME SD-8361 X1 31 7-2.DGN	APPROVED BY & DATE	PART NO. SEE SHEET 1	DRAWING NO. SD-8361 X1 31 7	SHEET NO. 2 OF 2
THIS DRAWING CONTAINS INFORMATION THAT IS PROPRIETARY TO ULTI-MATE INCORPORATED AND SHOULD NOT BE USED WITHOUT WRITTEN PERMISSION.				REV	