

PART DWG REV ISSUE	DATE	ECN NO.	APPROV BY	REL BY
-	-	-	-	-

WIRING COLOR CODE

- 1, 11, 21 — BLACK
- 2, 12 — BROWN
- 3, 13 — RED
- 4, 14 — ORANGE
- 5, 15 — YELLOW
- 6, 16 — GREEN
- 7, 17 — BLUE
- 8, 18 — VIOLET
- 9, 19 — GRAY
- 10, 20 — WHITE

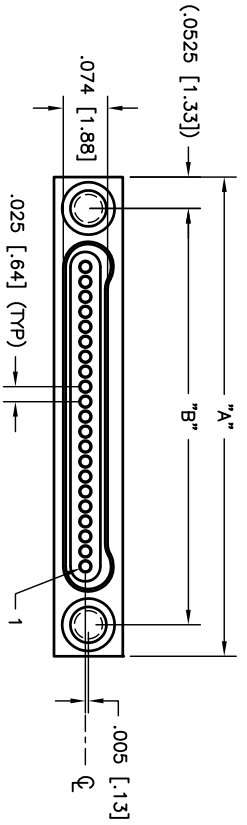
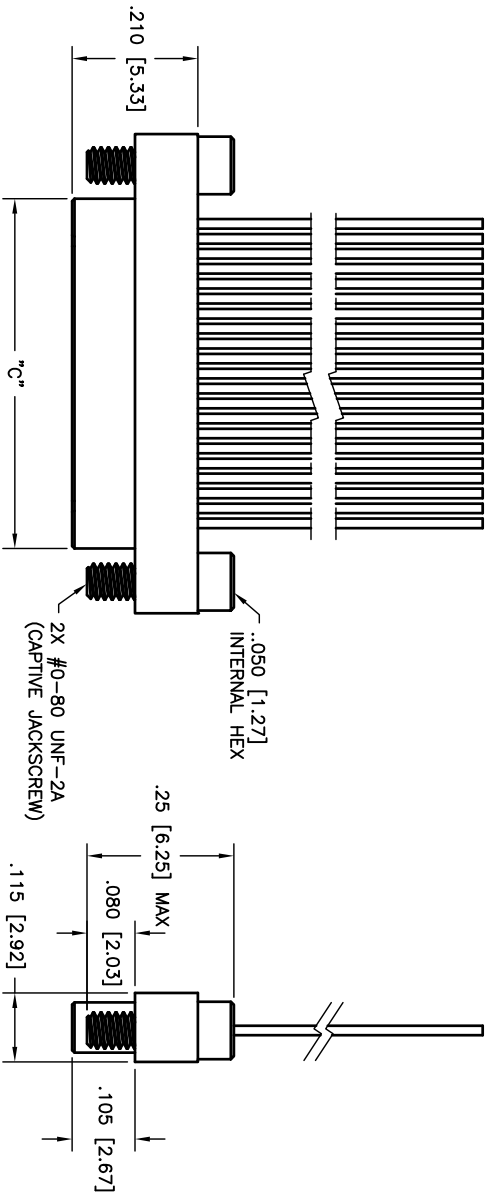

PART NO.	SIZE	"A"	"B"	"C"
833111622	9	.500 [12.70]	.395 [10.03]	.284 [7.21]
833121622	15	.650 [16.51]	.545 [13.84]	.434 [11.02]
833131622	21	.800 [20.32]	.695 [17.65]	.584 [14.83]
833141622	25	.900 [22.86]	.795 [20.19]	.684 [17.37]
833151622	31	1.050 [26.67]	.945 [24.00]	.834 [21.18]
833161622	37	1.200 [30.48]	1.095 [27.81]	.984 [24.99]
833171622	51	1.500 [39.37]	1.445 [36.70]	1.334 [33.88]

- 3. PERFORMANCE:** MEETS OR EXCEEDS M32139 PERFORMANCE SPECIFICATIONS
 CONTACT RATING: 1 AMPERE MAXIMUM
 INSULATION RESISTANCE: 5000 MEGOHMS MINIMUM @ 100 VDC
 CONTACT RESISTANCE: 0.071 VOLT MAXIMUM DROP @ 1.0 AMPS (.071 OHMS) W/6.00" OF WIRE LISTED BELOW, PER MIL-DTL-32139
- 2. MATERIALS:** SHELL: ALUMINUM 6061-T6, ELECTROLESS NICKEL PLATED PER AMS-C-28074
 INSULATOR: LCP (LIQUID CRYSTAL POLYMER) GLCP-30F
 CONTACT: BERYLLIUM COPPER PER ASTM B194, GOLD PLATED PER ASTM B488
 LEADS: 30 AWG, NEMA HP3, TYPE ET, COLOR CODED PER MIL-DTL-681, SYSTEM 1, EXCEPT USING 10 SOLID REPEATING COLORS, 18.0" +0.5/-0 LONG
 HARDWARE: 303 STAINLESS PER ASTM 582
- 1. MARKINGS:** UMI, DATE CODE, UMI P/N AS SPACE PERMITS
- NOTES: UNLESS OTHERWISE SPECIFIED

QUALITY SYMBOLS
 MAJOR =
 CRITICAL =
 SPC =

UNLESS SPECIFIED, ALL DIMENSIONS IN INCHES
 GENERAL TOLERANCES:
 3 PLACE ±.005
 2 PLACE ±.010
 ANGULAR ±2°

Uti+MATE CASE CODE
 58967

SCALE: 5:1
 DRAWN BY & DATE: UMI 03-09-10
 CHECKED BY & DATE:
 APPROVED BY & DATE:

TITLE: NANO-D SINGLE ROW CONNECTOR
 MALE, SIZE XX, NMLXX-1P02-30F6-18.0 S01

CAD FILENAME: SD-833131622.DWG
 THIS DRAWING CONTAINS INFORMATION THAT IS PROPRIETARY TO UTI+MATE
 INCORPORATED AND SHOULD NOT BE USED WITHOUT WRITTEN PERMISSION.

PART NO. SD-833131622
 DRAWING NO. Uti+MATE
 SHEET NO. 1 OF 1
 REV